



California Faucets®

# MANHATTAN

## HANDSHOWER & DIVERTER

### Features

- Over 30 finishes including 14 PVD finishes
- Solid brass construction
- Handshower: Maximum flow rate: 2.5 gpm (9.5 L/m) or 2.0 gpm (7.6 L/m) for "WE" (water efficient) model
- Handshower: 1/2" MIP inlet with self-clean rubber jets
- Handshower elbow: 1/2" FIP swivel nut with 1/2" MIP inlet
- Valve: Anti-siphon backflow prevention with 1/4 turn between outlet ports
- Hose: 84" Black poly braided hose. Provides durable, quiet & no damage to trim finish during operation
- Comes as a complete set with trim and valve
- For additional product offerings, see [www.californiafaucets.com](http://www.californiafaucets.com)

### 53.1-XX WE-53.1-XX

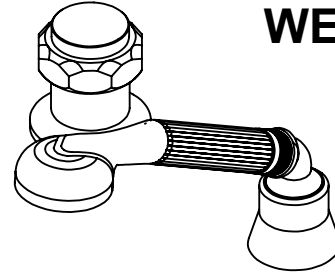

\*SHOWN WITH -DM RING

### Codes/Standards Applicable

Meets or exceeds the following at date of manufacture:

- ASME A112.18.1/CSA B125.1

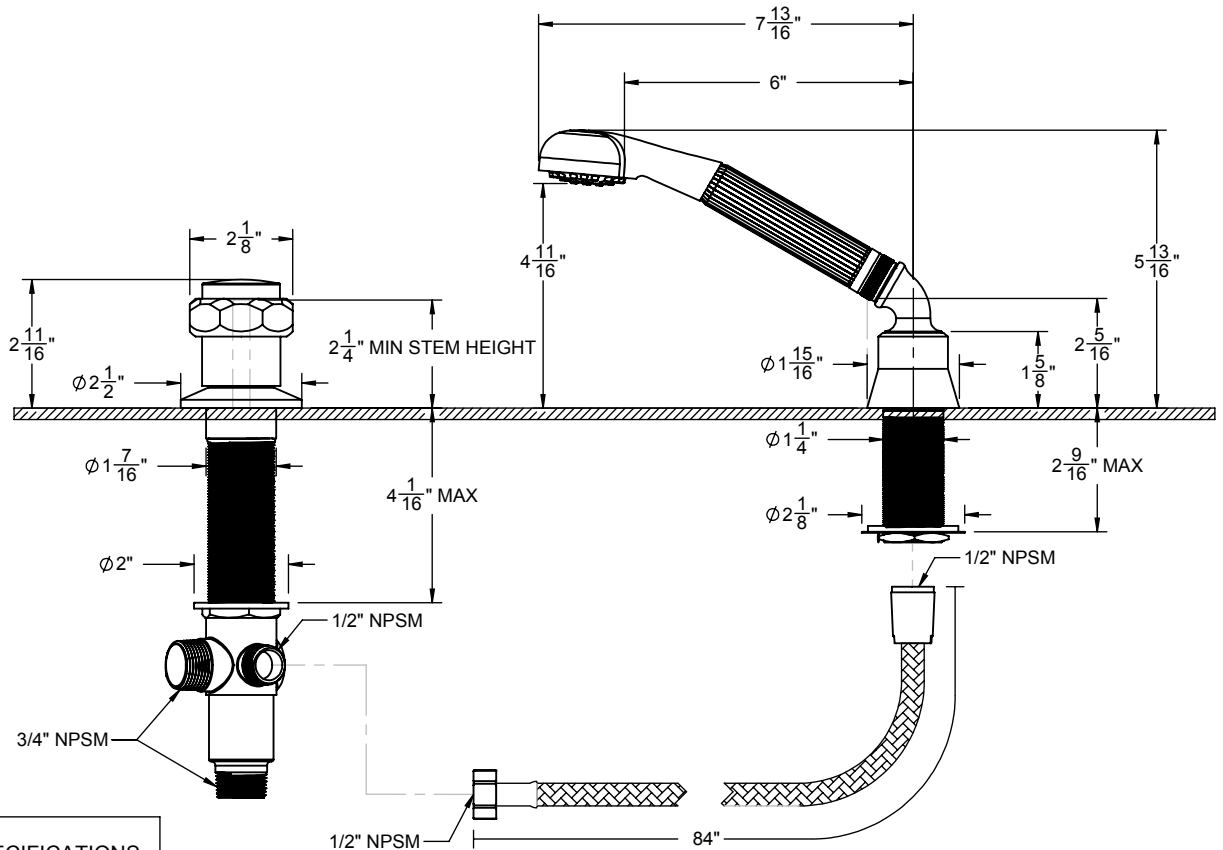
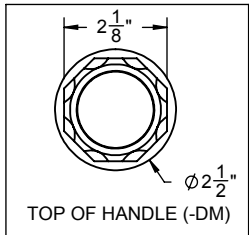
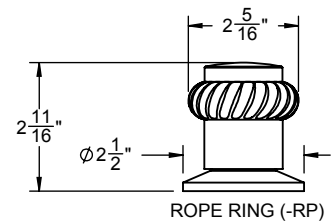
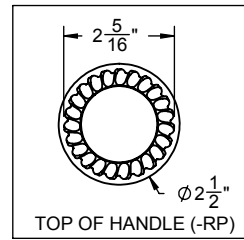
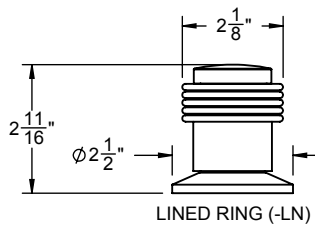
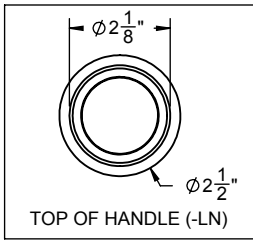

#### THROUGH-HOLE SPECIFICATIONS

|         | MIN       | RECOMENDED |
|---------|-----------|------------|
| SHOWER: | Ø 1-1/4"  | Ø 1-1/4"   |
| VALVE:  | Ø 1-7/16" | Ø 1-1/2"   |

ALL DIMENSIONS SHOWN TO NEAREST 1/16"